

N20-810-16

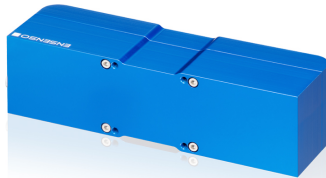

## Specification

### Technical data

Minimum working distance	240 mm
Maximum working distance	270 mm
Optimum working distance	250 mm
Focal length	8 mm
Mass	550 g
Vergence angle	10.00
Resolution (h x v)	1280 x 1024
Dimensions H/W/L	50.0 mm x 175.0 mm x 50.0 mm
f-number	1.6
Base line	100 mm
Power consumption	9.5 W

## N20-810-16

### Measurement volume

Distance	Z resolution	View field size X	View field size Y	Optics blur	Pixel size
230 mm	0.044 mm	178.20 mm	157.64 mm	2.458 px	0.154 mm
232 mm	0.045 mm	180.62 mm	159.01 mm	2.317 px	0.155 mm
234 mm	0.046 mm	183.04 mm	160.38 mm	2.178 px	0.157 mm
236 mm	0.047 mm	185.46 mm	161.75 mm	2.041 px	0.158 mm
238 mm	0.047 mm	187.88 mm	163.12 mm	1.906 px	0.159 mm
240 mm	0.048 mm	190.29 mm	164.49 mm	1.773 px	0.161 mm
242 mm	0.049 mm	192.71 mm	165.87 mm	1.642 px	0.162 mm
244 mm	0.050 mm	195.13 mm	167.24 mm	1.513 px	0.163 mm
246 mm	0.051 mm	197.55 mm	168.61 mm	1.387 px	0.165 mm
248 mm	0.052 mm	199.97 mm	169.98 mm	1.262 px	0.166 mm
250 mm	0.052 mm	202.39 mm	171.35 mm	1.139 px	0.167 mm
252 mm	0.053 mm	204.81 mm	172.72 mm	1.212 px	0.169 mm
254 mm	0.054 mm	206.93 mm	174.09 mm	1.321 px	0.170 mm
256 mm	0.055 mm	208.56 mm	175.46 mm	1.424 px	0.171 mm
258 mm	0.056 mm	210.19 mm	176.83 mm	1.525 px	0.173 mm
260 mm	0.057 mm	211.82 mm	178.20 mm	1.625 px	0.174 mm
262 mm	0.057 mm	213.45 mm	179.57 mm	1.723 px	0.175 mm
264 mm	0.058 mm	215.08 mm	180.94 mm	1.820 px	0.177 mm
266 mm	0.059 mm	216.71 mm	182.31 mm	1.916 px	0.178 mm
268 mm	0.060 mm	218.34 mm	183.69 mm	2.010 px	0.179 mm
270 mm	0.061 mm	219.97 mm	185.06 mm	2.103 px	0.181 mm

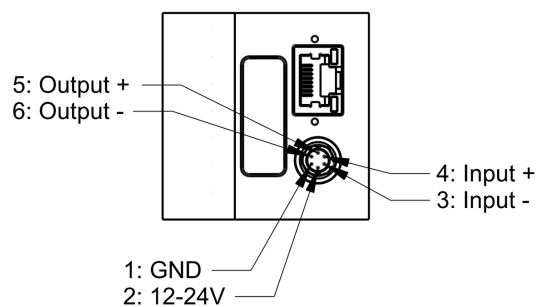
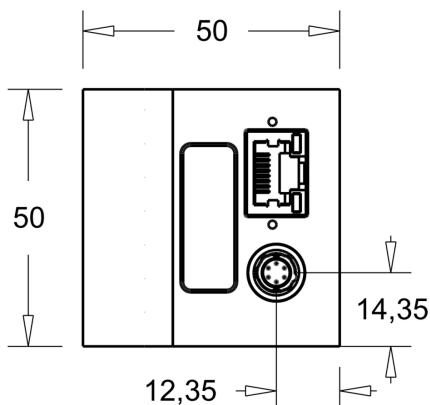
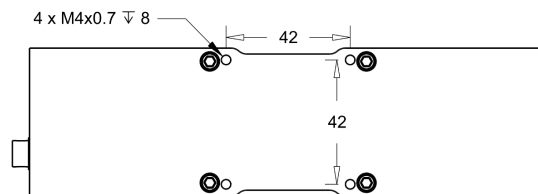
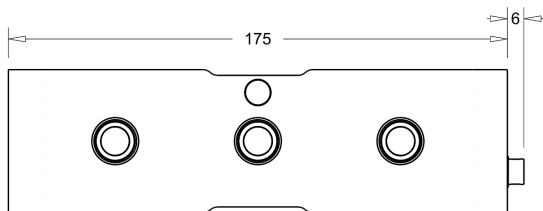

Subject to technical modifications

N20-810-16

